

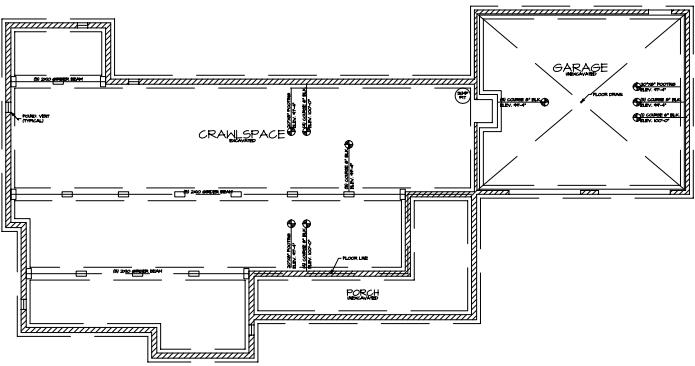

FRONT ELEVATION
A-1 SCALE: 1/4"=1'-0"



FOUNDATION PLAN
A-2 SCALE: 1/4"=1'-0"

- FOUNDATION PLAN NOTES:
1. FOUNDATION SHALL BE CONCRETE.
 2. FOUNDATION SHALL BE 12" MIN. THICK.
 3. FOUNDATION SHALL BE 18" MIN. THICK UNDER ALL EXTERIOR WALLS.
 4. FOUNDATION SHALL BE 12" MIN. THICK UNDER ALL INTERIOR WALLS.
 5. FOUNDATION SHALL BE 18" MIN. THICK UNDER ALL EXTERIOR WALLS.
 6. FOUNDATION SHALL BE 12" MIN. THICK UNDER ALL INTERIOR WALLS.
 7. FOUNDATION SHALL BE 18" MIN. THICK UNDER ALL EXTERIOR WALLS.
 8. FOUNDATION SHALL BE 12" MIN. THICK UNDER ALL INTERIOR WALLS.

D

STATISTICS:	
AREA:	EXISTING: PROPOSED:
FIRST FLOOR AREA:	N/A 1,825 S.F.
SECOND FLOOR AREA:	N/A N/A
TOTAL LIVING AREA:	N/A 1,825 S.F.
BASEMENT AREA:	N/A N/A
GARAGE AREA:	N/A 620 S.F.
TOTAL AREA:	N/A 2,445 S.F.

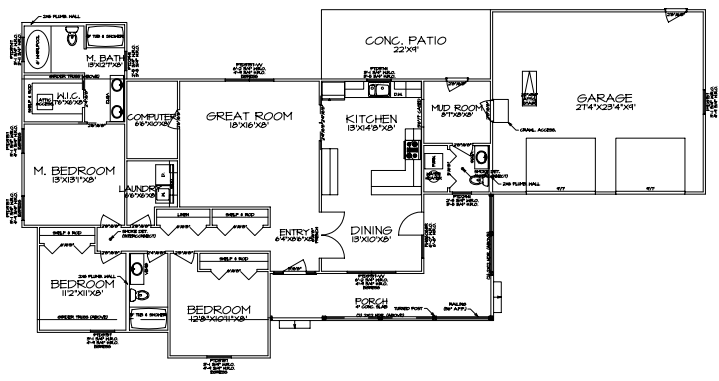

FIRST FLOOR PLAN
A-3 SCALE: 1/4"=1'-0"

- FIRST FLOOR PLAN NOTES:
1. FOUNDATION SHALL BE CONCRETE.
 2. FOUNDATION SHALL BE 12" MIN. THICK.
 3. FOUNDATION SHALL BE 18" MIN. THICK UNDER ALL EXTERIOR WALLS.
 4. FOUNDATION SHALL BE 12" MIN. THICK UNDER ALL INTERIOR WALLS.
 5. FOUNDATION SHALL BE 18" MIN. THICK UNDER ALL EXTERIOR WALLS.
 6. FOUNDATION SHALL BE 12" MIN. THICK UNDER ALL INTERIOR WALLS.
 7. FOUNDATION SHALL BE 18" MIN. THICK UNDER ALL EXTERIOR WALLS.
 8. FOUNDATION SHALL BE 12" MIN. THICK UNDER ALL INTERIOR WALLS.

GALLIVAN'S
DRAFTING & DESIGN
(217) 202-5998